

## Star - Specifications - Page 1

**Note:** - Height ranges and # of treads required for each range are shown below by model  
 - Extra treads for achieving various heights are included with each stair unit.

Model #	Rough Opening Size	Frame Size	Tread Depth / Width	Unit Weight	# Of Treads	Floor To Ceiling Height Range	Projection (See Page 2)	Landing Space
S2236	22 1/2" x 36"	22" x 35 1/2"	4 1/2" X 12"	79 lbs.	9	7' - 4" to 8' - 4"	27"	42"
					10	Over 8' - 4" to 9' - 0"	31"	44"
					11	Over 9' - 0" to 10'	35"	48"
S2254	22 1/2" X 54"	22" x 53 1/2"	4 1/2" X 12"	89 lbs.	9	7' - 4" to 8' - 4"	9"	42"
					10	Over 8' - 4" to 9' - 2"	13"	44"
					11	Over 9' - 2" to 10'	17"	48"
S2554	25 1/2" X 54"	25" x 53 1/2"	4 1/2" X 14"	94 lbs.	9	7' - 4" to 8' - 4"	9"	42"
					10	Over 8' - 4" to 9' - 2"	13"	44"
					11	Over 9' - 2" to 10'	17"	48"
S3060	30" X 60"	29 1/2" x 59 1/2"	4 1/2" X 16"	102 lbs.	9	7' - 4" to 8' - 4"	3"	42"
					10	Over 8' - 4" to 9' - 2"	7"	44"
					11	Over 9' - 2" to 10'	11"	48"

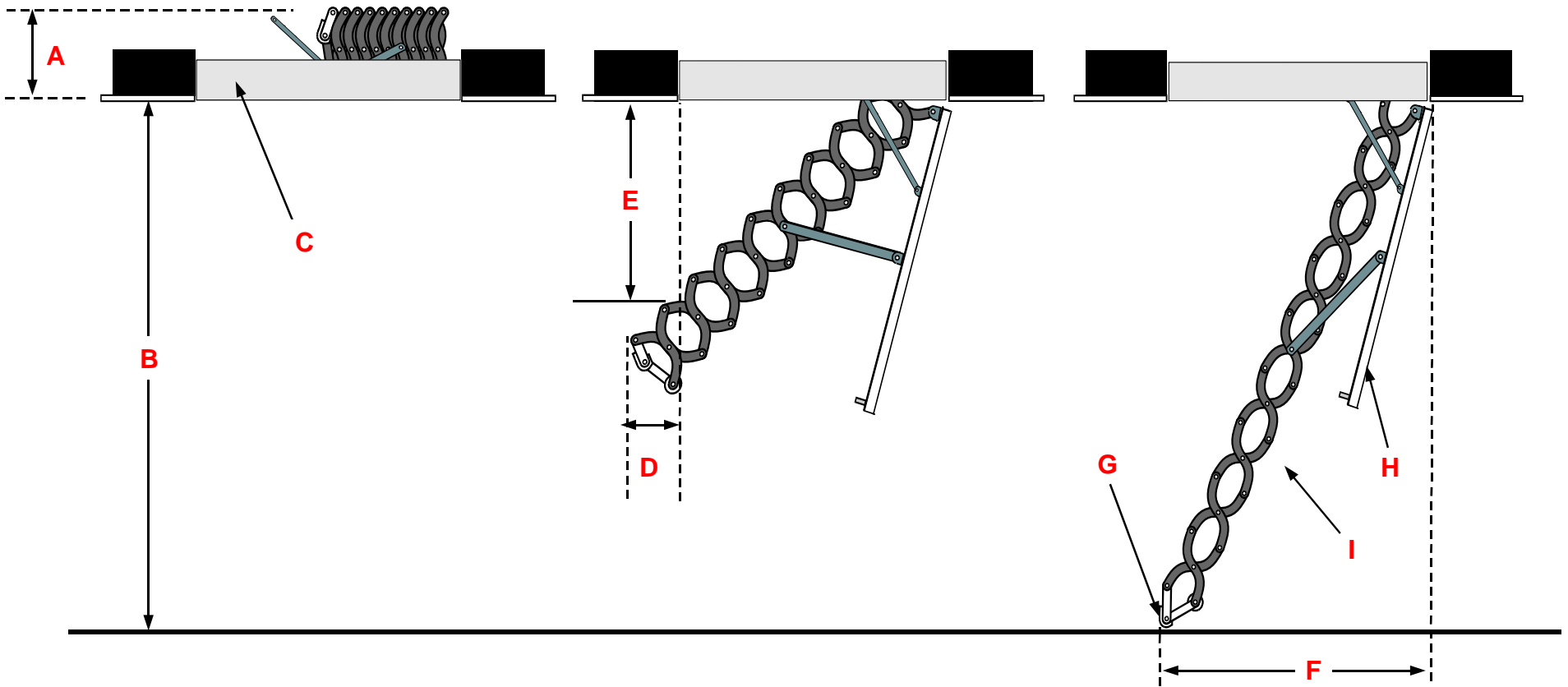

**A.** Closed Stair Height - 16"  
**B.** Floor to Ceiling Height  
**C.** Frame Height - 5 1/8"

**D.** Projection  
**E.** Height from ceiling at point of projection  
 22 1/2" X 36" = 17 3/4"  
 22 1/2" X 54" = 27 1/2"  
 25 1/2" X 54" = 27 1/2"  
 30" X 60" = 33 1/2"

**F.** Landing Space  
**G.** Only front bumper touches floor (Wheels are to protect door when stair is closed)  
**H.** Door Angle - 76°  
**I.** Stair angle - 70° +/-

Inside and Outside Frame Dimensions

**Rough Opening**  
22 1/2" x 36"  
**Outside Frame Dimension**  
22" X 35 1/2"

Hinged Side

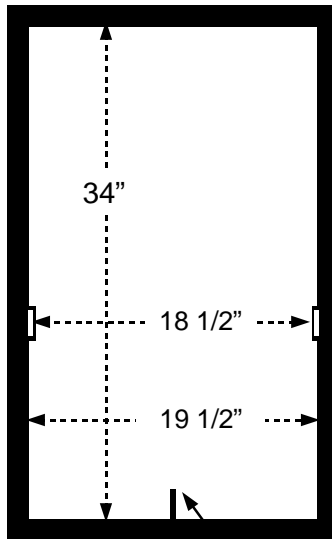

Latch - 1 1/2"

**Rough Opening**  
22 1/2" x 54"  
**Outside Frame Dimension**  
22" X 53 1/2"

Hinged Side

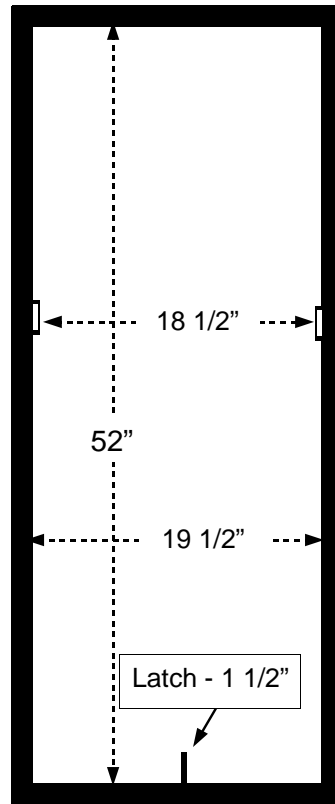

Latch - 1 1/2"

**Rough Opening**  
25 1/2" x 54"  
**Outside Frame Dimension**  
25" X 53 1/2"

Hinged Side

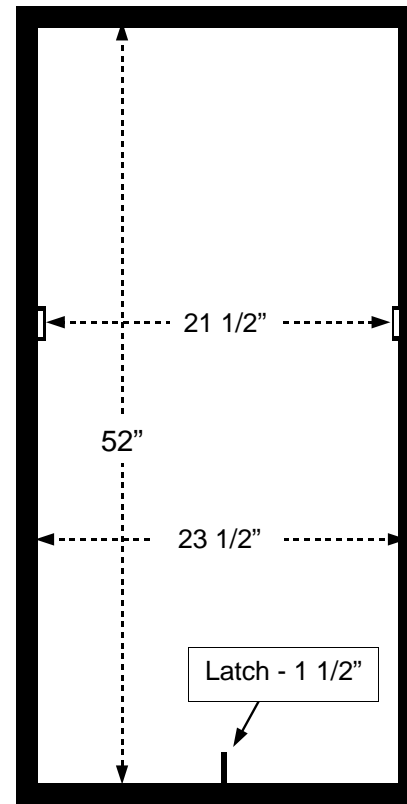

Latch - 1 1/2"

**Rough Opening**  
30" x 60"  
**Outside Frame Dimension**  
29 1/2" X 59 1/2"

Hinged Side

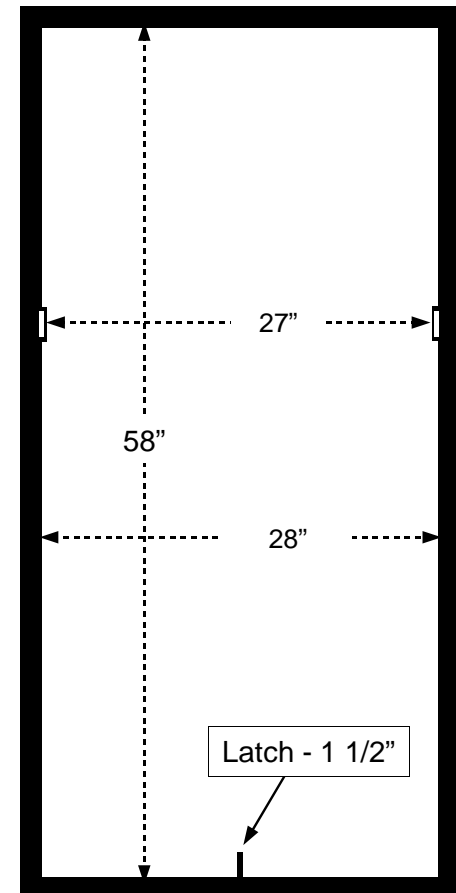

Latch - 1 1/2"