

MATERIALS AND COLORS

STEPS

- In birch plywood, thickness 1' 1/8" (29 mm)
- Excellent stability and high mechanical strength
- Non-toxic water-based coating: 3 layers of paint

HANDRAIL

- In plastic material in the same colour as the structure

STRUCTURE

- Steel modular elements
- Powder coated with matt scratch proof finish

RAILING

- Steel vertical columns painted in the same colour as the structure (distance between the columns less than 3' 7/8" - 10 cm)

Wood colour (steps)

Natural



Steel colour (structure and railing)

White

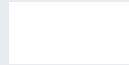

Silver grey



CONFIGURATIONS

SQUARE OPENING
(stair landing included)



ROUND OPENING
(stair landing included)



DIRECT LANDING AT THE FLOOR SLAB
(stair without landing)



UNIVERSAL LANDING WITH 60° OPENING: adaptable to any opening during installation.

4 STEPS EVERY 90°: this reduces the space occupied without losing comfort.

PACKAGE

1 box =

1 complete staircase of 13 steps (landing included)

Structure, steps, railing, handrail

or

1 complete staircase with 12 steps (without landing)

Structure, steps, railing, handrail

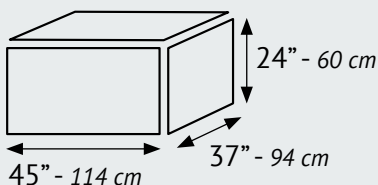

The measures of the box may vary

MEASUREMENTS valid for all the configurations

The **SYSTEM FOR ADJUSTING THE HEIGHT BETWEEN THE STEPS (RISE)** allows you to:

- Obtain different heights between floors with the same number of steps.
- Obtain the height between the floors as required with more or fewer steps (this means you can find the best compromise between the step height and the space occupied by the staircase).

ADJUSTABLE RISE

Height between steps

Min. 8' 1/8" - 20,5 cm
Max. 9' 1/2" - 24 cm

During installation it is possible to adjust the rise by changing the number of spacers

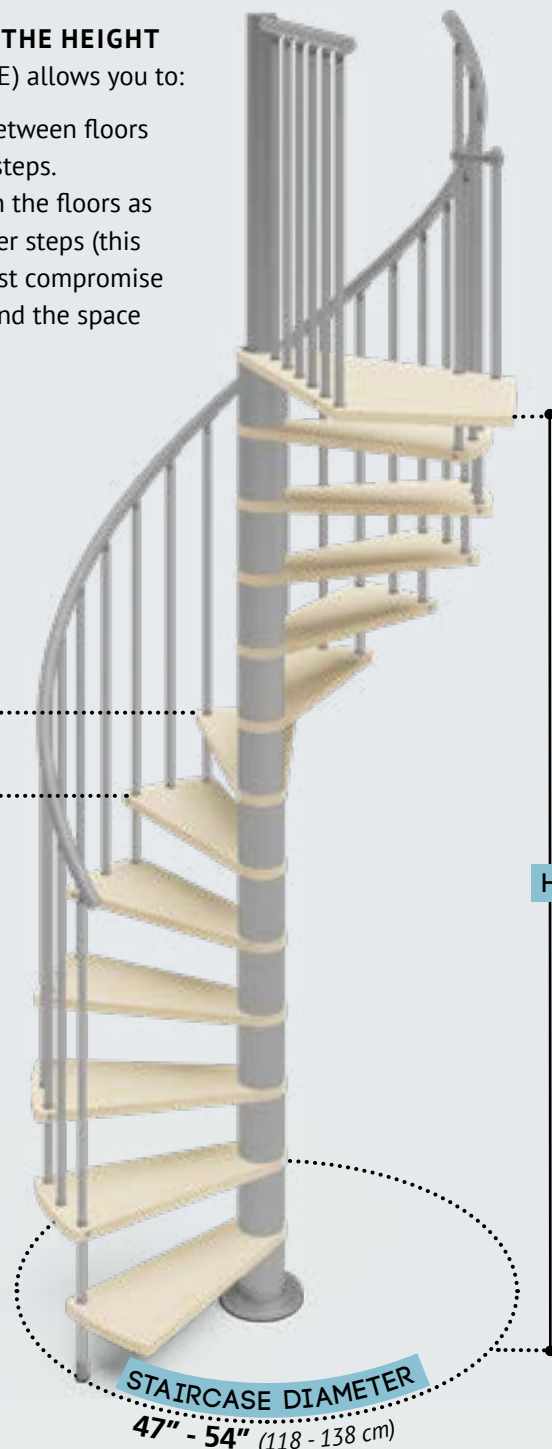
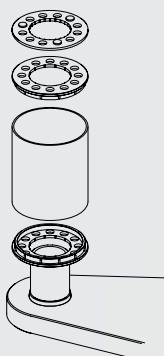

N. STEPS	HEIGHT BETWEEN FLOORS (H)
10 steps 1 box	Min. 6' 8 3/4" - 205 cm Max. 7' 10 1/2" - 240 cm
11 steps 1 box	Min. 7' 5" - 226 cm Max. 8' 8" - 264 cm
12 steps 1 box	Min. 8' 1" - 246 cm Max. 9' 5 3/8" - 288 cm
13 steps 1 box	Min. 8' 9 1/8" - 267 cm Max. 10' 2 7/8" - 312 cm
14 steps 1 box + 1 extra step	Min. 9' 5" - 287 cm Max. 11' 1/4" - 336 cm
15 steps 1 box + 2 extra steps	Min. 10' 1 1/4" - 308 cm Max. 11' 9 3/4" - 360 cm
16 steps 1 box + 3 extra steps	Min. 10' 9 1/8" - 328 cm Max. 12' 7 1/8" - 384 cm

Add more steps to reach greater heights.

- H = Finished floor to finished floor height.
- Staircase landing included: top universal landing fixed at the same level as the finished upper floor.
- Staircase without landing: top step fixed one rise below finished upper floor.
- Ceiling opening diameter: staircase diameter + 2" (5 cm).

DIRECTION OF ASCENT

Clockwise Counter clockwise

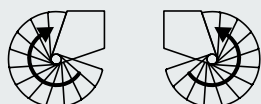

ACCESSORIES

Extra step (with structure and railing).

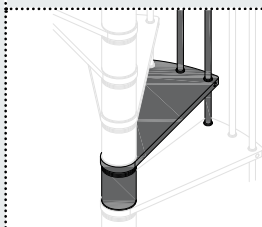

Balustrade for upper floor 39" (100 cm).

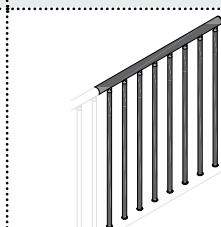

Extra section of internal post (needed for heights over 10' 5 5/8" - 319 cm).

